

Automatic

Grain Mills

CSU1000

Features

- Two-stage reduction process for maximum control
- Top rolls are coarse for primary reduction
- Bottom rolls are fine to produce the exact amount of reduction required for the job
- One point adjustment sets the gap between the rolls to control particle size.

Specifications

Roll Size	9"D x 18" L (23 x 46)
Shaft Size	2.00" (5.1)
Drive Belts (motor & rolls)	4
Weight (less motor)	1560 lb (708)
Length	61" (155)
Height	65" (165)

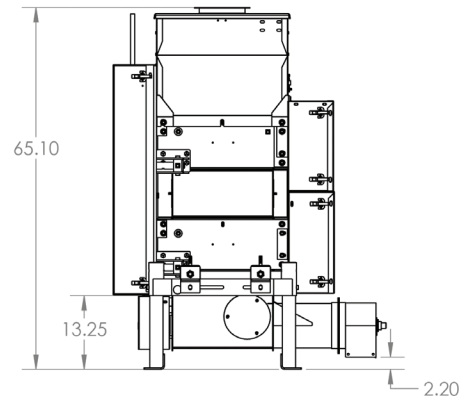
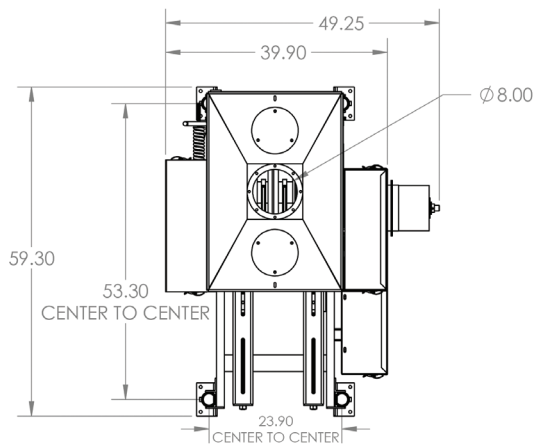

Email: info@automaticag.com
800-336-4336 • automaticag.com